



San José State University

San Jose Downtown Association, June 2018



Introduction

Dr. Mary A. Papazian
SJSU President













This is a placeholder. I need bullets.

Agenda





LAUNCH: CRS-8

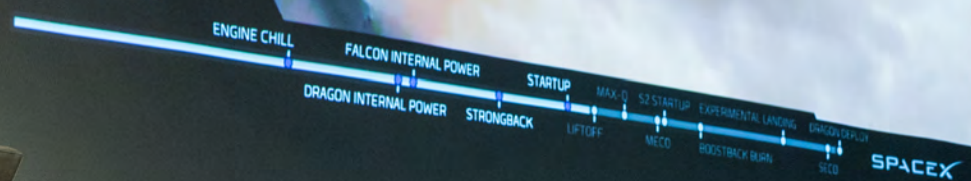

paseoprototyping.org





LAUNCH: CRS-8

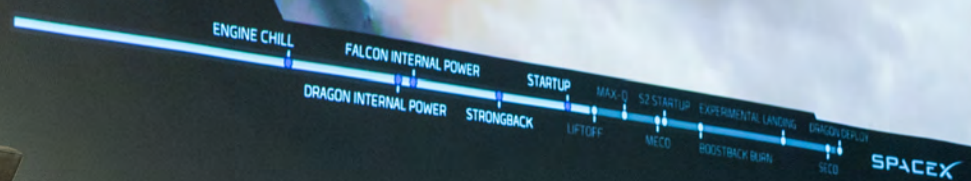

paseoprototyping.org





LAUNCH: CRS-8

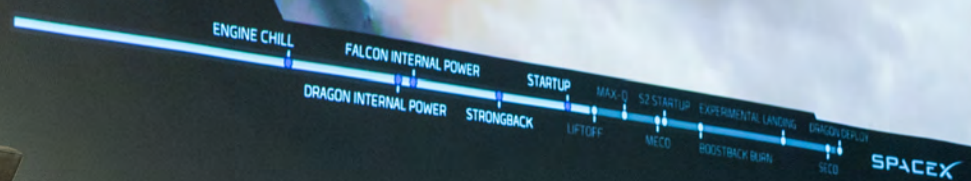

paseoprototyping.org



South Campus



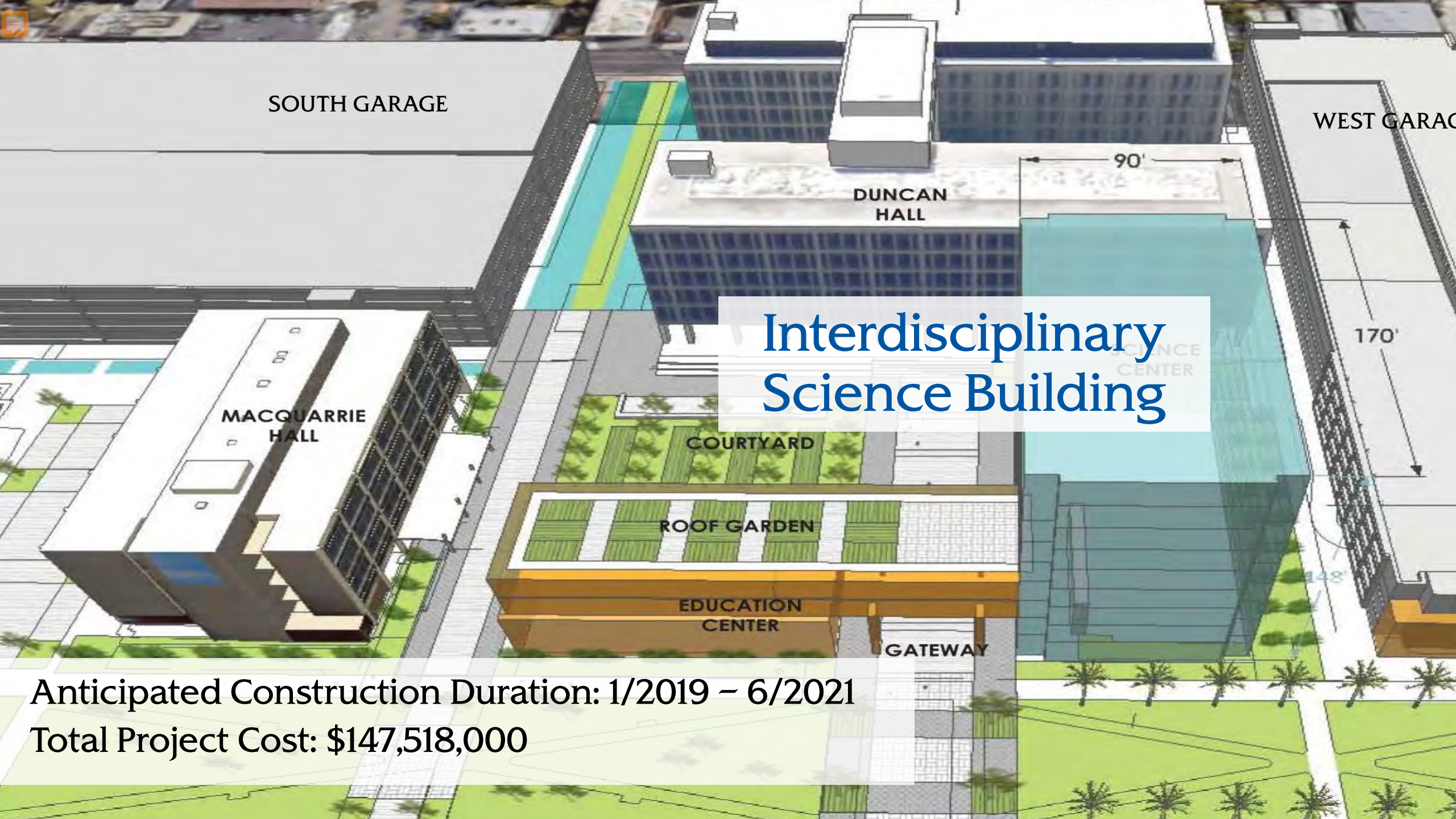

SOUTH GARAGE

WEST GARAGE

DUNCAN
HALL

90'

Interdisciplinary Science Building

170'

MACQUARRIE
HALL

COURTYARD

ROOF GARDEN

EDUCATION
CENTER

GATEWAY

Anticipated Construction Duration: 1/2019 – 6/2021
Total Project Cost: \$147,518,000



LAUNCH: CRS-8

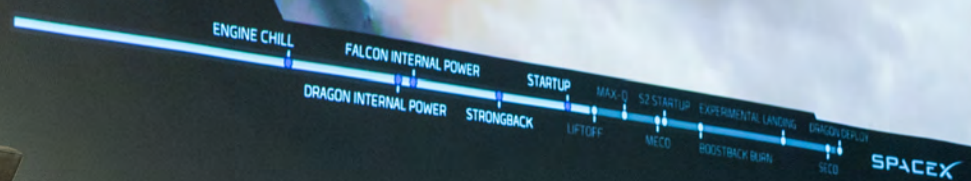

paseoprototyping.org









LAUNCH: CRS-8

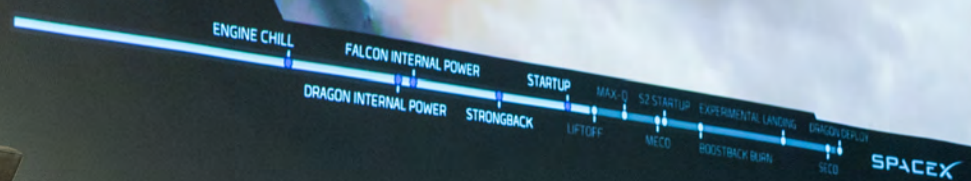

paseoprototyping.org





Closing Comments



The background image shows a wide-angle view of a university campus. In the foreground, a paved walkway leads towards a modern building with a facade of perforated metal panels. Several tall palm trees are scattered throughout the scene, some in the foreground and others in the background. A few people are walking on the path, and a street lamp is visible on the left. The entire image has a blue color overlay.

SJSU

SAN JOSÉ STATE
UNIVERSITY

