



# Venue Rental Information Packet

**For more information or to schedule a tour, please contact:**

Emily Kennebeck – Production Manager (314) 935-2926  
[kemily@wustl.edu](mailto:kemily@wustl.edu)

Street Address:  
560 Trinity Avenue  
St. Louis, MO 63130

# Our Venues



## **Pillsbury Theatre**

Features a terrazzo floor and two Steinway B pianos, the venue can accommodate up to 300 guests. The spacious room allows for a variety of layouts and uses. The perfect fit for a small concert or reception.

## **E. Desmond Lee Concert Hall**

Traditional auditorium space provides 1,092 seats on a single gently sloped level. Featuring a partial-thrust stage and two Steinway D Pianos, this is the perfect venue for your concert or community gathering.



## **Recital Hall**

Beautiful and intimate, the Recital Hall features a Steinway B Grand Piano and seats up to 78 people.

## 560 Music Center Box Office Fees:

560 Music Center encourages all LESSEES selling tickets to utilize the 560 Music Center Box Office

Event Set-up Fee	\$75.00
Per Ticket Charge	\$0.75/ticket
Box Office Staff for the event	\$17.00/person/hour

- A 4% processing charge applies to all credit card sales (Visa, MasterCard, Discover, American Express) and WU Bear Bucks sales

LEESEES must provide the recommended number of ushers for their event as determined by the Production Manager.

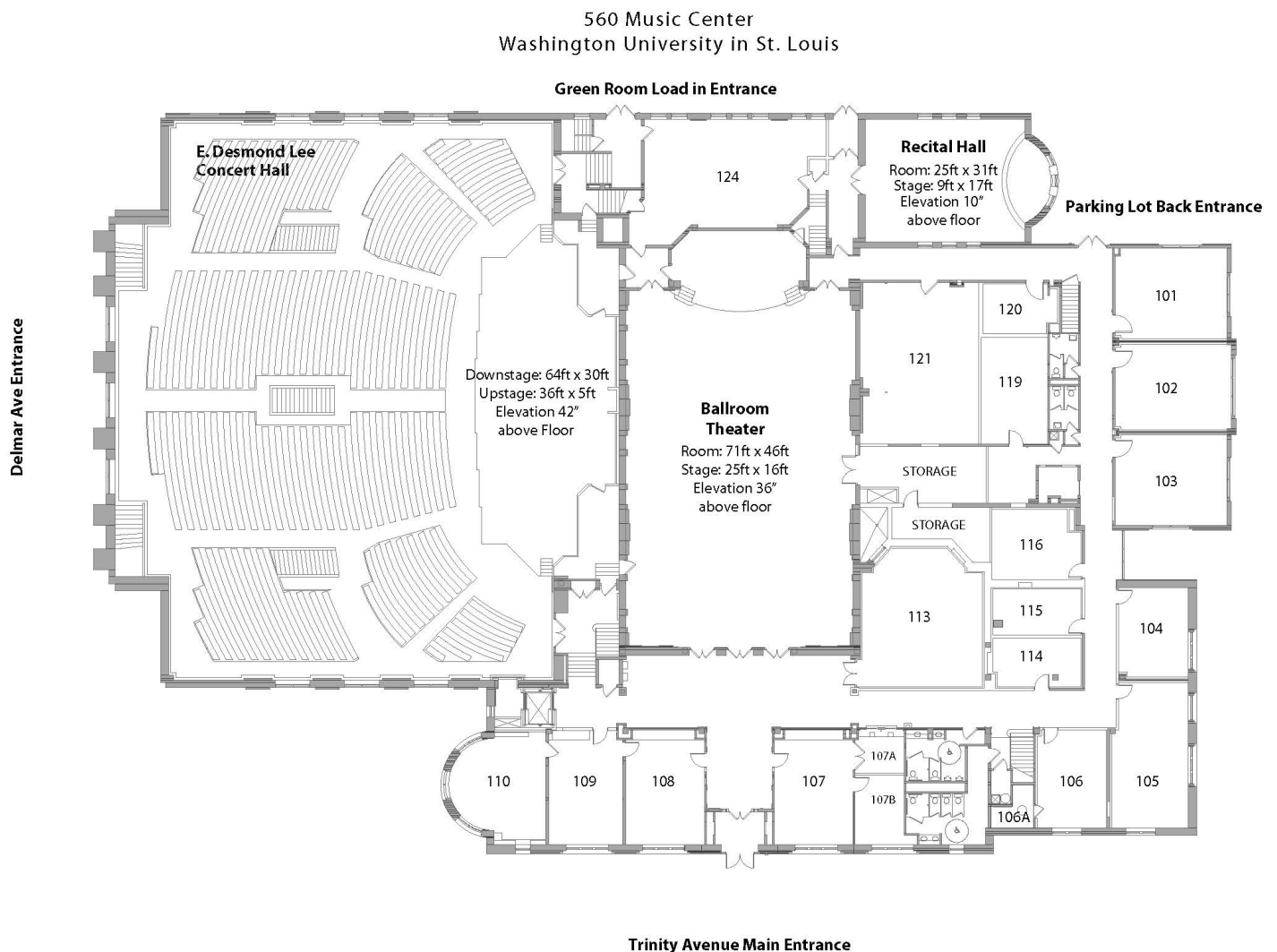

# Pillsbury Theatre

Large open ballroom, Art Deco style, features a terrazzo floor, historical reproduction chandeliers and sconce lighting. This space is ideal for recitals, lectures, seminars and receptions.

Entrance is via Trinity Ave Lobby.

## Specifications

**Address:** 560 Trinity Avenue, St. Louis, MO 63130

**Capacity:** 300 standing or seated theater style; 200 seated at tables

**Accessibility:** All entrances to the ballroom are wheelchair accessible, with mechanically assisted doors on the east side of the ballroom

**Main Floor Area:** 46' wide x 71' deep

**Stage Dimensions:** 25' wide x 16' deep; stage elevation 36" above the house floor

**Stage Type:** Proscenium with black stage curtain, no rigging capabilities or electrical battens

**Stage Floor:** Tongue and groove; no traps

**Stage Access:** A single side door at stage right; (5) permanent stairs from house level to downstage right and to downstage left; stage is not handicapped accessible

**Lighting:** (4) ETC Pro Four-Cell Pendants over stage  
(2) ETC Colorsound Fresnels (top light)  
(4) ETC Colorsound Pars (front light)  
(8) Chauvet Colorado Zoom Tours (front light)  
(6) ADJ Mega Bar RGBA LED Bars (portable for up lighting)  
Dimmable chandeliers, sconces and ceiling cans  
ETC Paradigm touchscreen, controlled from backstage right

**Audio:** (2) QSC K-12 powered speakers  
Allen & Heath Zed 10 mixer, controlled from backstage right  
(2) Shure SLX wireless microphones with handheld or lavalier

**Electrical:** (2) 20-amp circuits downstage right  
(1) 20-amp circuit upstage center  
(1) 20-amp circuit downstage center at house level  
(1) 20-amp circuit with (3) outlets along house left wall  
(1) 20-amp circuit on house right wall

**Pianos:** Steinway B grand piano on house level; Steinway B grand piano on stage. Pianos must remain in the room. Requests for tunings can be made in advance to the Production Manager and are at the expense of the LESSEE

**Loading:** Loading doors are at street level on the east side of the building; maximum 58' width and 94' height

**Support Spaces:** A multi-purpose room located directly behind the Pillsbury Theatre provides preparation space with deep well sink (no oven, no stove, no fryer, etc.); dedicated 20-amp circuit for food warmers; additional support space varies based on availability

# E. Desmond Lee Concert Hall

This traditional auditorium space provides 1,092 seats on a single gently sloped level and features a partial-thrust stage that can accommodate performances from solo recitals to full orchestra concerts.

Entrance is via Trinity Ave Lobby (wheelchair accessible) and Delmar Blvd Lobby.

## Specifications

**Address:** 560 Trinity Avenue, Saint Louis, MO 63130

**Capacity:** 1,092 seats in a fixed configuration

**Accessibility:** Elevator from ground floor to house level at the southwest entrance of the house

**Stage Dimensions:** 64' wide x 30' deep; stage elevation 42" above the house floor; 27' clearance upstage center

**Stage Type:** Open stage; no proscenium, curtains, rigging capabilities or electrical battens;

**Stage Floor:** Tongue and groove; no traps

**Stage Access:** (2) single side doors at stage right and left; (2) permanent stairs from house level on stage left and stage right; wheelchair lift from house floor to stage level is key activated and must be coordinated with Production Manager in advance

**Stage Lighting:** (16) ETC Pro Four-Cell Pendants over stage  
(6) ETC Source Four Parnels for stage wash  
(8) ETC Source Four 19-degrees (2 for conductor special, 6 for front light)  
(2) Canto 1200 Followspots on platforms in the back of house  
ETC Element 40 Lighting Control Console

**Audio System:** Renkus Heinz ICONYX Column Array with subwoofers; Midas M32 Digital Mixing Console; 40 x 8 Snake with monitor splitter and stage boxes; Shure ULXD4Q 4-channel wireless microphone system with handhelds and lavaliers (see mic list on extra equipment list)

**Projection:** Christie D13HD-HS, 13,000 lumens, 1DLP Laser Projector, controlled by Extron MPS-601 video switcher. Projector is permanently mounted in the rear of the concert hall for front projection. A motorized 21.3' x 12' Da-Lite projection screen is mounted upstage.

**Electrical:** (1) 100-amp single phase disconnect at backstage left  
(1) 200-amp three-phase disconnect located behind stage right below stage  
(3) 20-amp circuits located downstage in floor pockets

**Instruments:** (2) Steinway D Concert Grand Pianos; (4) Timpani; instruments are located permanently on stage; requests for tunings must be made in advance to the Production Manager and are at the expense of the LESSEE

**Loading:** Loading doors are 6' below stage at street level and located on the east side of the building. There are two sets of double doors, a seven step stairway, and one door stage right or double doors house left between loading doors and stage with six steps to stage level; Front side load-in with elevator to house level may be arranged through the Production Manager.

**Support Spaces:** (3) Dressing rooms on the second floor with counters and mirrors; one external unisex bathroom with two showers across from dressing rooms. Not handicapped accessible; additional support space varies based on availability.

**Note:** Food and beverages are not allowed on stage or in the audience; the elevator alcove must remain free from all cabling and equipment at all times.



# E. Desmond Lee Concert Hall

## Seating Chart

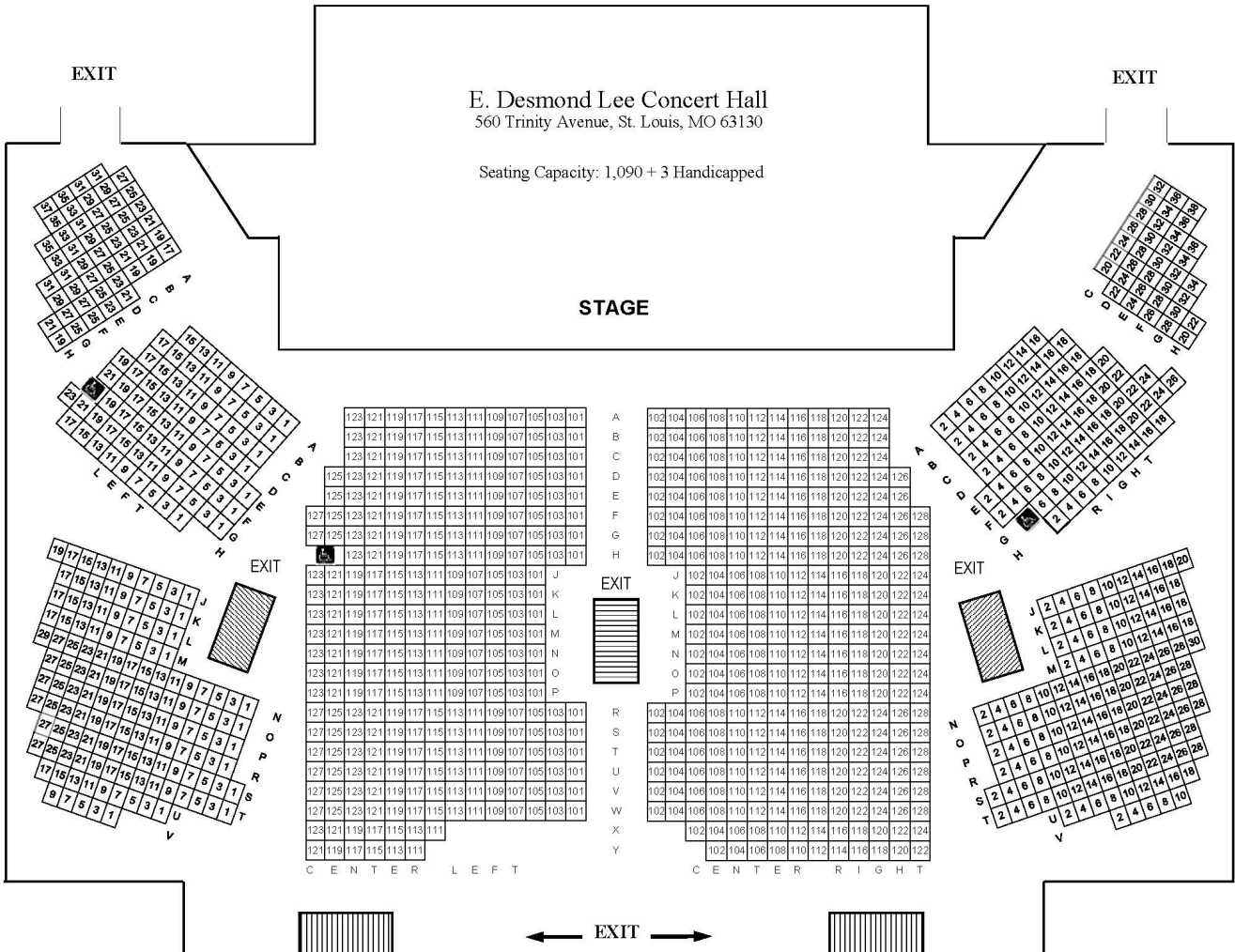

# Recital Hall

This venue is an intimate setting that features a small stage, stained-glass windows, a mosaic upstage wall, and is ideally suited for recitals, lectures, and meetings.

Entrance is via Trinity Ave Lobby

## Specifications

**Address:** 560 Trinity Avenue, Saint Louis, MO 63130

**Capacity:** (60) chairs theatre style standard set; expandable up to (78)

**Accessibility:** Entrance is handicapped accessible

**Stage Dimensions:** 17' wide x 9' deep; 10" above house floor

**Stage Type:** Proscenium; no curtains or drapes

**Stage Floor:** Tongue and groove; no traps. No rigging capabilities, grids, borders, lines, electrical battens, empty pipes, or pin rail

**Access:** Entrance is through (1) set of double doors measuring 58" wide x 96" high

**Lighting:** Typical room lighting; no stage lighting available

**Recording and Streaming:** (3) PTZ Optics 30X Pan Tilt Zoom Cameras, PTZ Optics Superjoy Controller, BlackMagic Design ATME Mini Extreme ISO, Midas M32R Mixing Console

**Instruments:** (1) Steinway B Grand Piano permanently on the stage floor

**Loading:** Loading doors are at street level and located on the east side of the building

**Support Spaces:** Multipurpose room located directly across the hallway provides essential preparation space. Additional support space varies based on availability.

**Note:** Food and beverages are not allowed in this space

# Additional Equipment

(All equipment is accessible upon request based on availability)

## Microphone List:

- (4) Neumann KM184 (2 matched pairs)
- (2) AKG C414 XLS (matched pair)
- (2) AKG C451 B (matched pair)
- (4) Shure KSM137 (2 matched pairs)
- (4) Rode NT5 (2 matched pairs with interchangeable omni capsules)
- (2) Sennheiser e614
- (2) AKG P170
- (3) Audio Technica U853R
- (1) AKG D112 MKII
- (4) Shure SM58
- (2) Shure SM57
- (4) Countryman E6 Earset Mic for wireless belt packs
- (5) Whirlwind Hot Box Active Reference DI Boxes

## Audio Monitors:

- (2) QSC K-12 powered loudspeaker, 12"; 2-way;
- (4) Mackie SRM451 powered loudspeaker, 12" 2-way

## Portable Audio Rack:

- (1) Presonus Studiolive AR16 Mixing Console
- (1) BSS FCS966 31 Band Graphic Equalizer
- (1) DBX 1046 Compressor
- (4) Shure SLX Wireless Microphone Systems

## Video:

- (1) Sony HXR-NX100 Full HD Camcorder
- (1) NEC U300X Ultra Short Throw Projector
- (1) Da-Lite Fast-Fold 9' x 12' Projection Screen

## Lighting:

- (6) ADJ Megabar RGBA LED Stage Bars for up lighting



# Additional Equipment

## Staging:

(1) Wenger Conductor Podium

(1) Oak Lectern

(75) Manhasset #48 Music Stands

(5) Wenger Signature Choral Risers

Pipe and Drape

- (16) 4' x 16' black velour drape panels
- (6) Adjustable uprights 9'-16' and (6) Bases with pins
- (4) telescoping crossbar; 7', 10', 12'

## Tables and Chairs:

(12) Cabaret Tables; 3' diameter; adjustable height

(24) 5' Rounds; seat 6-8 people comfortably

(7) 6' Rectangular Folding and (5) 8' Rectangular Folding

(300) Green Upholstered Banquet Chairs

(100) Black Upholstered Orchestra Chairs; available only in Concert Hall