

Gephardt Institute for Civic and Community Engagement

Atkin Residency in the Art of Democracy Application

Personal Information

* First Name

* Last Name

Preferred First Name

Pronouns

Local Mailing Address

* Street Address or PO Box

* City, State, Zip

* Hometown

* WashU Email

Alternate Email

City, State or City, Country

* Phone

* Student ID Number

Anticipated Graduation

* Year

* Major(s)

Minor(s)

*** School(s)**

- Arts & Sciences
- School of Continuing & Professional Studies
- McKelvey School of Engineering
- Olin Business School
- Sam Fox School of Design & Visual Arts

*** How did you hear about this opportunity? Check all that apply.**

- Social Media
- Gephardt Institute Website
- Faculty / Staff Member
- Friend
- Word of Mouth
- Newsletter
- Poster / Flyer / Advertisement
- Program Alumni
- Information Session
- Tabling
- Other

Mentor and Recommender Information

Please list your primary mentor below and one alternative contact who could serve as your mentor. Your primary mentor should be the individual who submits a mentor letter of support for your application.

The Atkin Resident is expected to meet weekly with a mentor who can provide guidance on their project. The resident is expected to co-develop a meeting and deliverable schedule with their mentor, and the mentor can expect to spend 4-5 hours/month meeting with the student from August 2024 through April 2025.

Ideally, the mentor should be a subject area expert in the media the resident aims to pursue through their project. The mentor can be a WashU staff or faculty member or a St. Louis community member. Mentors will be compensated an honorarium of \$500 per semester (\$1,000 for the academic year) for their time and effort.

* Primary Mentor Name

* Primary Mentor Title/Position

* Primary Mentor Email

* Primary Mentor Phone Number

* Alternative Mentor Name

* Alternative Mentor Title/Position

* Alternative Mentor Email

* Alternative Mentor Phone

Please list the contact information for your recommender. Your recommender should be someone who knows you in an academic capacity such as a WashU professor or WashU academic advisor.

* Recommender Name

* Recommender's Title/Position

* Recommender WashU Email Address

* Recommender Phone

Please note: In addition to completing this application, you must submit one (1) [letter of support from your primary mentor](#) and one (1) [recommendation from an academic advisor or professor at WashU](#). For your application to be considered, both documents must be submitted by Thursday, March 7 at 9 p.m. CST.

Portfolio Upload and Essay Questions

Please upload a portfolio of your work here. Your portfolio should include 3-5 recent works that demonstrate your artistic vision and offer clear examples of the kind of work you might complete during the residency. Please submit a PDF slide deck of 3-5 slides (one artistic work per slide) with short descriptions of the work (80-100 words with title, media, dimensions, date completed, contextual info, and artistic intent) and a web link to the work, if applicable (e.g. audio, writing samples, video). The content on the slides can vary based on media.

- For architecture, drawing, fashion, painting, photography, printmaking, sculpture, culinary arts: Pdf slides with 3-5 recent works, high quality images
- For dance, digital media, film, theatre: Pdf slides with 3-5 recent works, links with up to 15 minutes of video
- For music: Pdf slides with 3-5 recent works, links with up to 15 minutes of audio
- For writing: Pdf slides with 3-5 recent works, links with up to 10 pages of writing

Please be sure that any files you link from cloud storage are set to public sharing/accessible via link.

* Upload Your Portfolio

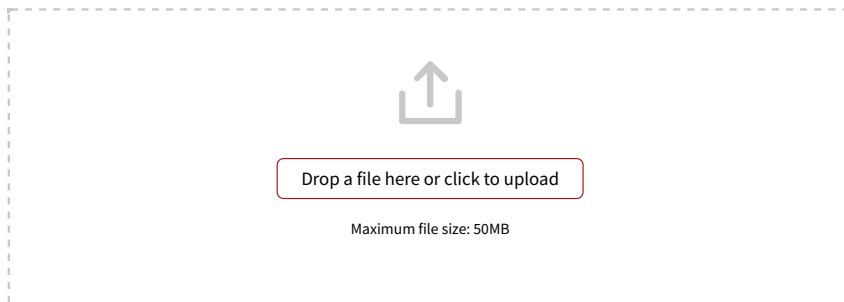

The Atkin Residency in the Art of Democracy offers students funding and support to complete a yearlong artistic project that explores paradoxes, evolutions, histories, stories, and possibilities of U.S. democracy. Please share 2-3 democracy-related themes or questions you would be eager to explore through the Atkin Residency and describe how these themes/questions contribute to enriching discourse around

* democracy.

0 of 300 max words

Please describe the proposed project you would explore through the residency. What medium/media do you plan to work with? What artistic influences will you explore? How will the public interact with the final project? (Note: If selected for the residency, you will not be required to implement this exact project. We anticipate that your *** project may evolve during the residency.**)

0 of 300 max words

300 word limit

The \$10,000 residency stipend can be used to offset your living expenses, in lieu of academic year earnings, and for project needs such as studio space, materials, honoraria for additional performers, etc. Please share a breakdown of how you anticipate using the funding and any known expenses associated with your project, *** using a bulleted list.**

Visual Text

b i link b-quote del ins img ul ol li code more close tags

300 word limit. Use the “Visual” tab on this field to format your text and create bulleted lists.

Previous

Review and Submit